

# PATRIOT (SDSS)

The Patriot cable cleats are metallic cable cleats which have been designed, constructed, and tested in accordance with the International Standard IEC 61914: Cable cleats for electrical installations to ensure the securing and retention of cables, without sustaining damage to the cable.

The range is fabricated from 316L stainless steel, giving it high creep strength whilst providing excellent corrosion resistance in the harshest of environments. The Patriot cable cleats are available for trefoil application / formation for diameters of 13mm to 128mm in 25 sizes.

The cleat has three M10 fixing clearance holes within one base allowing versatility to the installer during installation, and is designed to enable the product to be secured to a variety of mounting surfaces. The hinge opens fully allowing the cables to be easily placed within the cable cleat to aid the installer before closing and securing via the mouth piece bolt.

Liners come as standard which help to restrain the cable(s) within vertical applications. Where thermal elongation of cables occurs, the liner also provides a layer of protection between the cable sheath and the cable cleat during normal operation. This additional layer protects the cable from chafing on any mounting surface due to differential movements such as those found in marine and offshore applications. The liners also assist in the extra protection of cable(s) in the event of short circuit fault conditions. The standard liners supplied are classified as Low Smoke and Fume Zero Halogen (LSFOH), Phosphorus-free.



## FEATURES

- Third party certification to IEC 61914
- 316L stainless steel
- 13 - 128mm in 25 sizes for trefoil formation / application
- Short circuit rating of 135kA peak fault
- Operating temperature -50°C to +60°C
- Standard Polymer Liners are classified as Low Smoke and Fume Zero Halogen (LSFOH), Phosphorus-free
- Combined single (M10) or two bolt (M10) fixing design

TECHNICAL DATA & CLASSIFICATION	
TYPE	6.1.3 Composite SDSS - Standard Duty Stainless Steel
DESIGN SPECIFICATION	IEC 61914
TEMPERATURE FOR PERMANENT APPLICATION	-50°C to +60°C IEC 61914 clause 6.2
NEEDLE FLAME TEST	Pass - 120 second flame application time IEC 61914 clause 10.0, 10.1, IEC 60695-11-5
LATERAL LOAD TEST	Refer to CMP Products, IEC 61914 clause 9.3
AXIAL LOAD TEST	0.6kN, IEC 61914 clause 9.4
IMPACT RESISTANCE	Pass - Very heavy IEC 61914 clause 6.3, 6.3.5, 9.2
MATERIAL	316L Stainless Steel with Standard Polymer Liner Standard Polymer Liners are classified as Low Smoke and Fume Zero Halogen (LSFOH), Phosphorus-free

SHORT CIRCUIT TESTING TO IEC 61914 - CLAUSE 9.5			
TREFOIL FORMATION			
One short circuit 300mm fixed cleat centres	Two short circuits 300mm fixed cleat centres	Two short circuits 600mm fixed cleat centres	Two short circuits 600mm fixed cleat centres
0.1 sec	1 sec	0.1 sec	1 sec
135kA Peak	80kA Peak	108kA Peak	75kA Peak
58.8kA r.m.s	38.3kA r.m.s	49.1kA r.m.s	35.7kA r.m.s

300mm PATRIOT SDSS (0.1 SEC)	
CABLE OD (mm)	PEAK KA
36	135.0
38	138.7
43	147.5
59	172.8
65	181.4

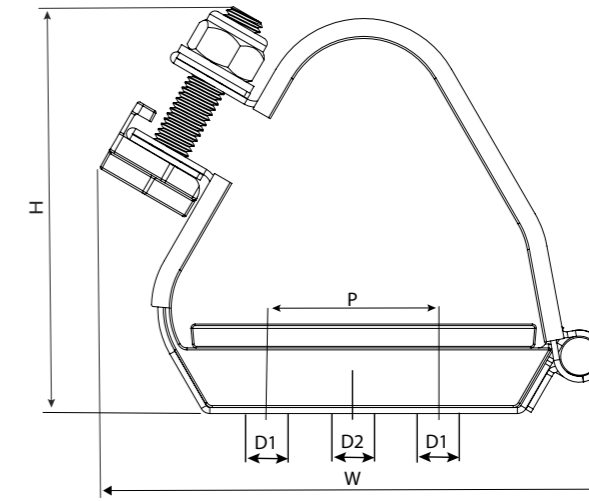
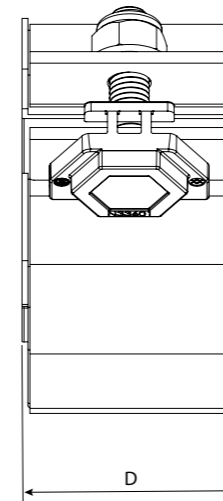

CABLE CLEAT SELECTION TABLE									
PATRIOT PART NO.	CABLE Ø RANGE TAKE (mm)	DIMENSIONS (mm)						WEIGHT (g)	
		W	H	D	P	FIXING HOLE Ø			
						D1	D2		
SDSS013017	13-17	84	71	60	N/A	N/A	1 X M10	304	
SDSS017021	17-21	100	76	54	25	2 x M10	1 x M10	326	
SDSS019024	19-24	99	81	54	25	2 x M10	1 x M10	331	
SDSS023028	23-28	101	86	54	25	2 x M10	1 x M10	340	
SDSS027032	27-32	104	91	54	25	2 x M10	1 x M10	353	
SDSS030035	30-35	106	94	54	25	2 x M10	1 x M10	362	
SDSS033038	33-38	108	98	54	25	2 x M10	1 x M10	374	
SDSS036042	36-42	127	102	54	50	2 x M10	1 x M10	441	
SDSS040046	40-46	130	107	54	50	2 x M10	1 x M10	453	
SDSS044050	44-50	134	115	54	50	2 x M10	1 x M10	466	
SDSS048055	48-55	137	124	54	50	2 x M10	1 x M10	483	
SDSS051058	51-58	140	130	54	50	2 x M10	1 x M10	495	
SDSS055062	55-62	160	137	54	75	2 x M10	1 x M10	549	
SDSS059066	59-66	160	144	54	75	2 x M10	1 x M10	565	
SDSS063070	63-70	161	152	54	75	2 x M10	1 x M10	580	
SDSS067074	67-74	164	159	54	75	2 x M10	1 x M10	594	
SDSS071078	71-78	167	167	54	75	2 x M10	1 x M10	607	
SDSS074082	74-82	190	174	54	75	2 x M10	1 x M10	683	
SDSS077085	77-85	193	180	54	75	2 x M10	1 x M10	688	
SDSS082088	82-88	194	185	54	75	2 x M10	1 x M10	699	
SDSS088096	88-96	202	200	54	75	2 x M10	1 x M10	728	
SDSS096103	96-103	215	214	54	75	2 x M10	1 x M10	756	
SDSS103111	103-111	235	228	54	75	2 x M10	1 x M10	846	
SDSS111119	111-119	249	243	54	75	2 x M10	1 x M10	874	
SDSS119128	119-128	266	260	54	75	2 x M10	1 x M10	909	

Coatings are available upon request by adding the following suffixes to the ordering reference - EC for epoxy coating, PC for polyester coating and TC for thermoplastic coating. Example order reference for epoxy coating suffix EC (SDSS030035EC). Fasteners required to secure the cable cleat to the support structure are not included but can be supplied upon request - see cleat fixing pack TD5752. Isolation/separation pads (to prevent corrosion between two dissimilar metals) are not included but can be supplied upon request - see isolation/separation pad TD5736.